

DUPIXENT[®]
(dupilumab)

WELCOME TO YOUR ASTHMA TREATMENT

This handbook has been produced by Sanofi and is for patients who have been prescribed DUPIXENT (dupilumab). DUPIXENT is used with other asthma medicines for the maintenance treatment of severe asthma in adults and adolescents (aged 12 and older) whose asthma is not controlled with their current asthma medicines.

sanofi

REGENERON[®]

MAT-XU-2300594 (v1.0)
February 2023

Sanofi and Regeneron are collaborating in a global development programme and commercialisation for DUPIXENT.

LET'S GET TO KNOW DUPIXENT BETTER

Welcome to a next step in your severe asthma treatment. You might have a few questions about starting another type of medication, so we have created this handbook to help you feel confident and prepared about what to expect.

We know living with severe asthma is tough, but we're on this journey together. This handbook, along with the Starter Kit, should provide you with some more information about your treatment.

Warmly,
DUPIXENT Patient Support Team

CONTENTS

- | | |
|-----------------------------------|---------|
| » What is severe asthma? | Page 3 |
| » How is asthma normally treated? | Page 11 |
| » How does DUXIPENT work? | Page 15 |
| » How do I self-inject correctly? | Page 27 |
| » My notes | Page 45 |
| » Asthma support groups | Page 51 |

WHAT IS SEVERE ASTHMA?

Helpful information for you
and those around you.

ASTHMA IS A COMMON CONDITION THAT AFFECTS THE LUNGS

Severe asthma refers to asthma which does not get better with the usual treatment, meaning that a different treatment approach may be necessary to control the symptoms.

Finding the right support and treatment can help people manage their symptoms and get back to their everyday life.

Over
200,000
people in the
UK have
severe asthma

Severe asthma
affects adults and
children and it can
develop at any age

It can be
unpredictable
and different for
each individual

SYMPTOMS OF SEVERE ASTHMA

People with asthma have times when their breathing becomes more difficult than normal.

However, people with severe asthma may have breathing problems more often, making management harder.

Common symptoms include:



Wheezing

(a whistling sound when breathing)



Breathlessness

(it may feel like breathing is very hard work)

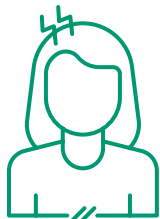

Chest tightness

(it may feel like a band is tightening around it)

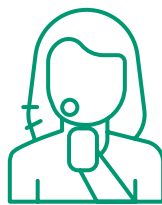

Coughing

Most people with severe asthma require frequent use of inhaled medications or even daily oral steroids to provide relief from their symptoms. This lack of control of symptoms may leave people feeling unhappy or frustrated.



You may wish to speak further to your healthcare professional team if you are struggling to control your symptoms

Certain factors may lead to asthma symptoms

Most asthma symptoms often occur in response to a trigger.

Common triggers include:

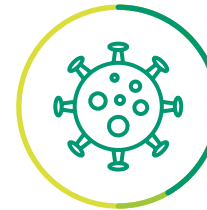

Infections



Allergies



Smoke, fumes and pollution



Medicines



Emotions



Weather changes



Mould or damp



Exercise

Understanding what may be triggering your severe asthma may help you try to avoid them to control your symptoms.

Asthma affects the airflow in your lungs

Your lungs contain small tubes that bring air in and out of your lungs called bronchioles.

Asthma affects bronchioles and larger airway tubes called bronchi.

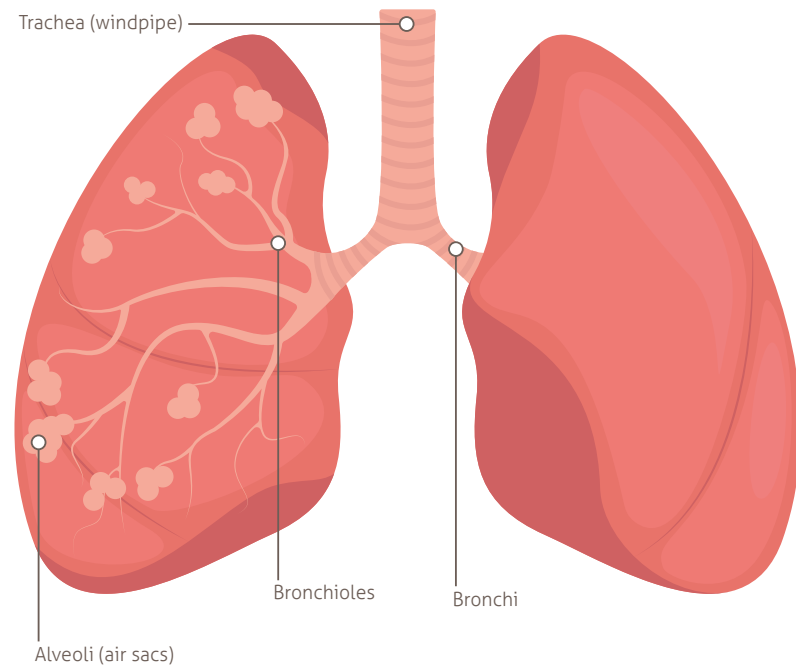

Asthma causes inflammation (swelling) and increased sensitivity in your airways, leading to the symptoms of asthma.

NORMAL AIRWAY

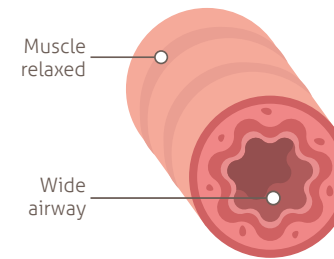

The muscles lining your breathing tubes are normally relaxed, maintaining a wide airway space that lets in plenty of air to reach your lungs.

ASTHMA/SEVERE ASTHMA

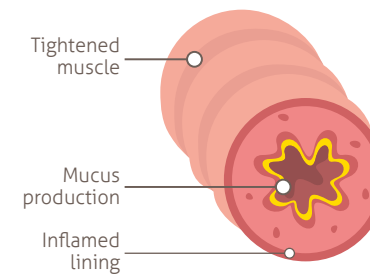

The breathing tubes are inflamed and narrower with increased mucus production. This inflammation is prolonged with severe asthma.

ASTHMA ATTACK

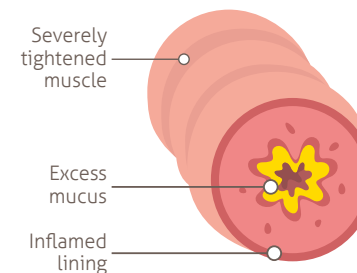

During an asthma attack the breathing tubes temporarily become very narrow, making it hard to get enough air in and out of your lungs.

Treatment options are used to reduce inflammation and sensitivity in your lungs, leading to fewer symptoms.

HOW IS ASTHMA NORMALLY TREATED?

Helpful information for you
and those around you.



ASTHMA TREATMENT IS SPECIFIC TO INDIVIDUAL NEEDS

Asthma treatments can help control symptoms



INHALERS

Inhalers can help to:

1. Relieve symptoms when they occur (reliever inhalers)
2. Stop symptoms developing (preventer inhalers)

Some may need inhalers that do both (known as combination inhalers).



TABLETS

Tablets may be recommended if using your inhaler(s) alone does not help to control your symptoms.

Leukotriene receptor antagonists (LTRAs)

LTRAs help symptoms of asthma by reducing inflammation (swelling) in your airways.

Theophylline

Theophylline relaxes the muscles in your airways, allowing more air to get in easier.

Steroids

Steroid tablets also reduce inflammation. They can be taken as:

- » An immediate treatment when you have an asthma attack
- » Every day as a long-term treatment to prevent symptoms – only if you have very severe asthma and inhalers don't control your symptoms

Other treatments, such as injections or surgery may be offered to people with severe asthma whose symptoms cannot be controlled successfully.

DUPIXENT is a type of treatment that acts on the immune system to improve the signs and symptoms of severe asthma.

DUPIXENT is injected under the skin and targets the underlying cause of the inflammation in severe asthma.

HOW DOES DUPIXENT WORK?

A few things you might be wondering about DUPIXENT. This section will help you understand your treatment.

DUPIXENT is a medicine that is intended to reduce inflammation

DUPIXENT is used to treat adults and adolescents 12 years and older as add-on maintenance treatment for severe asthma with Type 2 inflammation characterised by raised blood eosinophils and/or raised fractional exhaled nitric oxide (FeNO), who are inadequately controlled with high-dose inhaled corticosteroids (ICS) plus another medicinal product for maintenance treatment.

YOU HAVE JUST BEEN PRESCRIBED DUPIXENT

And you might have questions such as:

- » How does DUPIXENT work? **Page 18**
- » What do I need to know before starting to use DUPIXENT? **Page 20**
- » How do I use DUPIXENT? **Page 23**
- » What are the possible side effects? **Page 25**

HOW DOES DUPIXENT WORK?

Inflammation and sensitivity in the lungs leads to severe asthma symptoms.

DUPIXENT blocks the action of two proteins that trigger inflammation

Interleukin 4 (IL-4) and interleukin 13 (IL-13) are proteins that participate in turning on the cell signals for inflammation in the body. DUPIXENT blocks the IL-4 and IL-13 signalling.

Inflammation in severe asthma:

People with severe asthma may have an excess of IL-4 and IL-13. Without IL-blocking therapy, excess IL-4 and IL-13 can trigger signals that lead to lung inflammation, causing the symptoms of asthma.

ACTIVATED DAMAGE-CAUSING CELL

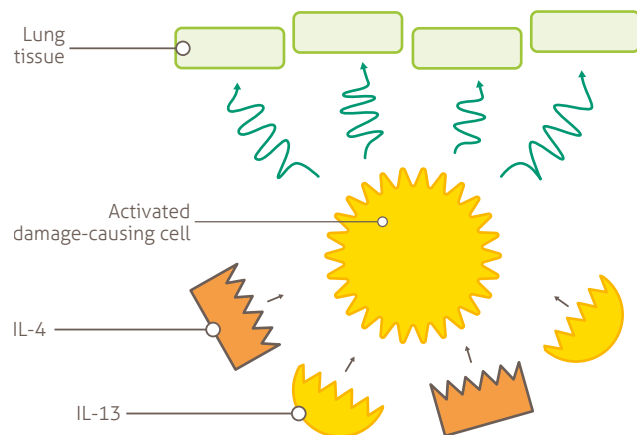

Less inflammation in severe asthma:

DUPIXENT blocks the action of IL-4 and IL-13 and helps reduce asthma inflammation in the lungs.

DUPIXENT BLOCKING THE ACTION OF IL-4 AND IL-13

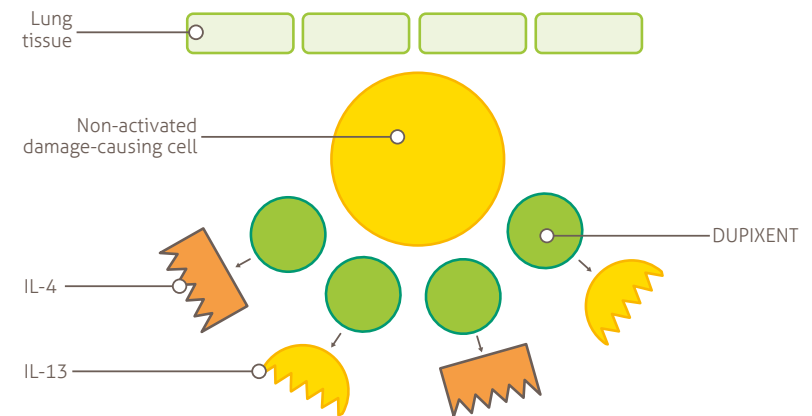

It is important that you keep taking your treatment even if you don't feel improvements right away.

Medicines, especially those for long-term diseases like severe asthma, can take a while before you see results.

Do not stop using DUPIXENT without speaking to your healthcare professional first.

WHAT DO I NEED TO KNOW BEFORE STARTING TO USE DUPIXENT?

Please refer to the **Patient Information Leaflet** in the pack for full safety information and instructions for injection.

Do not use DUPIXENT if:

- » You are allergic to DUPIXENT (dupilumab) or any of the other ingredients of DUPIXENT (L-arginine hydrochloride, L-histidine, polysorbate 80, sodium acetate, acetic acid, sucrose, water for injections)
- » If you are not sure whether you may be allergic to any component of DUPIXENT, ask your healthcare professional for advice before using DUPIXENT

Talk to your healthcare professional about any other medical conditions that you may have before using DUPIXENT.

Allergic reactions

DUPIXENT can cause serious side effects, including allergic (hypersensitivity) reactions. You must look out for signs such as:

- » Breathing problems
- » Swollen lymph nodes
- » Swelling of the face, lips, mouth, throat or tongue
- » Hives
- » Fainting, dizziness, feeling lightheaded
- » Itching
- » Fever, general ill feeling
- » Joint pain
- » Skin rash

Stop using DUPIXENT and tell your healthcare professional or get medical help immediately if you notice any signs of an allergic reaction.

DUPIXENT in treating severe asthma

DUPIXENT is not a rescue medicine and should not be used to treat a sudden asthma attack.

Remember to not change or stop other asthma medicines without talking to your healthcare professional. Talk to your healthcare professional before you stop DUPIXENT or if your asthma remains uncontrolled or worsens during treatment with DUPIXENT.

Parasitic (intestinal parasites) infection

DUPIXENT may weaken your resistance to infections caused by parasites. If you already have a parasitic infection it should be effectively treated before you start treatment with DUPIXENT. If you become infected while you are taking DUPIXENT and do not respond to anti-parasitic treatment, then you should stop taking DUPIXENT until your infection is resolved. Talk to your healthcare professional if you have any of the following signs of a parasitic infection:

- » Diarrhoea
- » Greasy stools
- » Gas
- » Dehydration
- » Upset stomach

If you are planning to travel to or have lived in a region where these infections are common, please speak to your healthcare professional.

Eye problems

Tell your healthcare professional if you have any new or worsening eye problems, including:

- » Eye pain
- » Changes in vision

Eosinophilic conditions

Rarely, patients taking an asthma medicine may develop inflammation of blood vessels or lungs due to an increase of certain white blood cells (eosinophilia). It is not known whether this is caused by DUPIXENT. This usually, but not always, happens in people who also take a steroid medicine which is being stopped or for which the dose is being lowered.

Talk to your healthcare professional immediately if you develop a combination of symptoms such as a flu-like illness, pins and needles or numbness of arms or legs, worsening of pulmonary symptoms, and/or a rash.

Anyone involved in your healthcare should know you have been prescribed DUPIXENT

In order for your healthcare professionals to make the most informed decisions about your health, it is important that they know all the medicines you are taking, including DUPIXENT.

Tell your healthcare professional:

- » If you are using, have recently used or might use any **other medicines**
- » If you have recently had or are due to have a **vaccination**

Live and live-attenuated vaccines should not be given whilst being on DUPIXENT. In the case that you might have surgery or find yourself in hospital, it is important to tell anyone treating you that you are taking DUPIXENT.

There may be other aspects of your life that you would like to discuss with your healthcare professional while using DUPIXENT

Pregnancy and breast-feeding

Talk to your healthcare professional before using DUPIXENT if you are pregnant, think you may be pregnant, or are planning to have a baby. The effects of this medicine on pregnant women and/or unborn babies are not known. Therefore, it is preferable to avoid the use of DUPIXENT in pregnancy unless your healthcare professional advises you to use it.

Talk to your healthcare professional before using DUPIXENT if you are breast-feeding or are planning to breast-feed. You and your healthcare professional should decide if you will breast-feed or use DUPIXENT. You should not do both.

Driving and using machines

The use of DUPIXENT is not expected to affect your ability to drive or use machines. However, if you are feeling tired or unwell after you use DUPIXENT, you should not drive or use machines.

Sodium content

DUPIXENT is essentially 'sodium-free' as it contains less than 1 mmol of sodium (23 mg) per 300 mg dose.

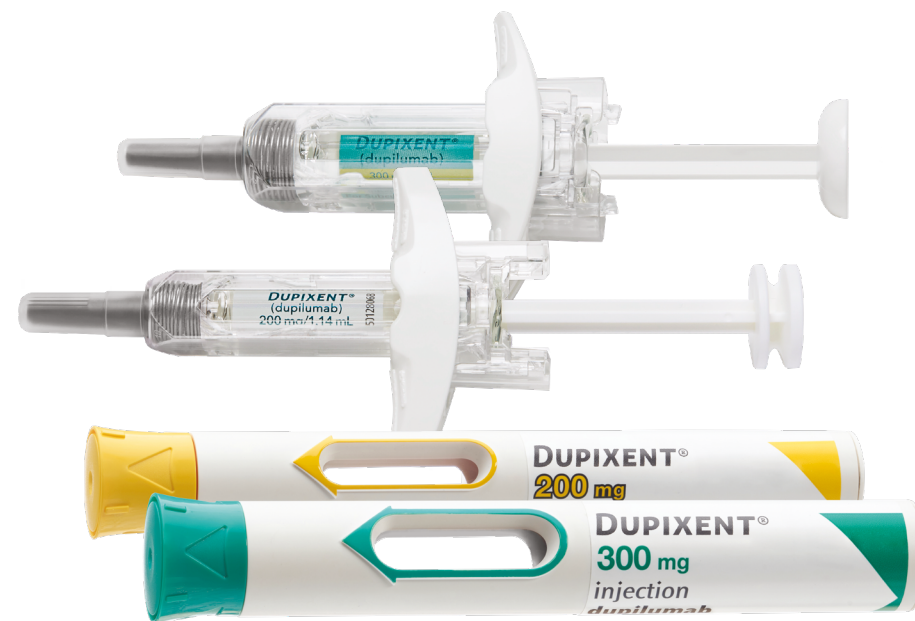

HOW DO I USE DUPIXENT?

Always use DUPIXENT exactly as your healthcare professional has told you – check and discuss with your healthcare professional if you are not sure.

DUPIXENT is given by injection under your skin (subcutaneous injection). You and your healthcare professional should decide if you should inject DUPIXENT yourself.

Only inject DUPIXENT yourself after you have been trained by your healthcare professional. A caregiver may also give you your DUPIXENT after they have received proper training.

Please refer to the **Patient Information Leaflet** in the pack for full safety information and instructions for injection and read the '**How do I self-inject?**' section in the handbook before using DUPIXENT.

How much DUPIXENT is given and for how long?

Your healthcare professional will decide how much DUPIXENT you need and for how long. The recommended dose of DUPIXENT for adults and adolescents (12 years of age and older) is:

- » For patients with severe asthma and who are on oral corticosteroids or for patients with severe asthma and co-morbid moderate-to-severe atopic dermatitis or adults with co-morbid severe chronic rhinosinusitis with nasal polyposis, an initial dose of 600 mg (two 300 mg injections), followed by 300 mg every other week administered as subcutaneous injection
- » For all other patients, an initial dose of 400 mg (two 200 mg injections), followed by 200 mg every other week administered as subcutaneous injection
- » Do not stop using DUPIXENT without speaking to your healthcare professional first
- » If you use more DUPIXENT than you should, or forget to use DUPIXENT, please contact your healthcare professional immediately

WHAT ARE THE POSSIBLE SIDE EFFECTS?

Like all medicines, DUPIXENT can cause side effects, although not everybody gets them.

Please refer to page 26 for a list of potential side effects. Please refer to the **Patient Information Leaflet** in the pack for full safety information and instructions for injection.

When you start to use any medicine, it is important to notice how you are feeling and how it may be affecting you. For any treatment, you and your healthcare professional will have to choose the right balance of relief versus potential side effects that works for you.

Side effects: know, notice and tell

Knowing the possible side effects of your new medicine is the first step to resolving them.

If you notice any side effects, including those not mentioned in this handbook, tell your healthcare professional. By doing so, your healthcare professional will be able to make an informed decision on how DUPIXENT is working for you.

Here's an overview of possible side effects of DUPIXENT

Common side effects (may affect up to 1 in 10 people) include:

- ›› Injection site reactions
- ›› Eye redness and itching
- ›› Eye infection
- ›› Cold sores (on lips and skin)
- ›› Joint pain
- ›› An increase in a certain kind of white blood cell (eosinophils)

DUPIXENT can also cause **serious side effects**, including **rare allergic reactions**. The signs of allergic reaction may include:

- ›› Breathing problems
- ›› Swollen lymph nodes
- ›› Swelling of the face, lips, mouth, throat or tongue
- ›› Hives
- ›› Fainting, dizziness, feeling lightheaded
- ›› Itching
- ›› Fever, general ill feeling
- ›› Joint pain
- ›› Skin rash

If you get any side effects, talk to your healthcare professional. This includes possible side effects not listed in this handbook.

Know when to get in touch with your healthcare team

If you get any unusual symptoms, talk to your healthcare professional. This includes any possible side effects not listed in this leaflet. Talk to your healthcare professional about the right way to prepare and give yourself a DUPIXENT injection and follow the **'Instructions For Use'** leaflet that comes with DUPIXENT.

HOW DO I SELF-INJECT CORRECTLY?

A guide to using your single-use pre-filled syringe or pre-filled pen

DUPIXENT can be self-administered thanks to two devices, a pre-filled syringe or a pre-filled pen. Please refer to your healthcare professional to find which device is the most appropriate for you.

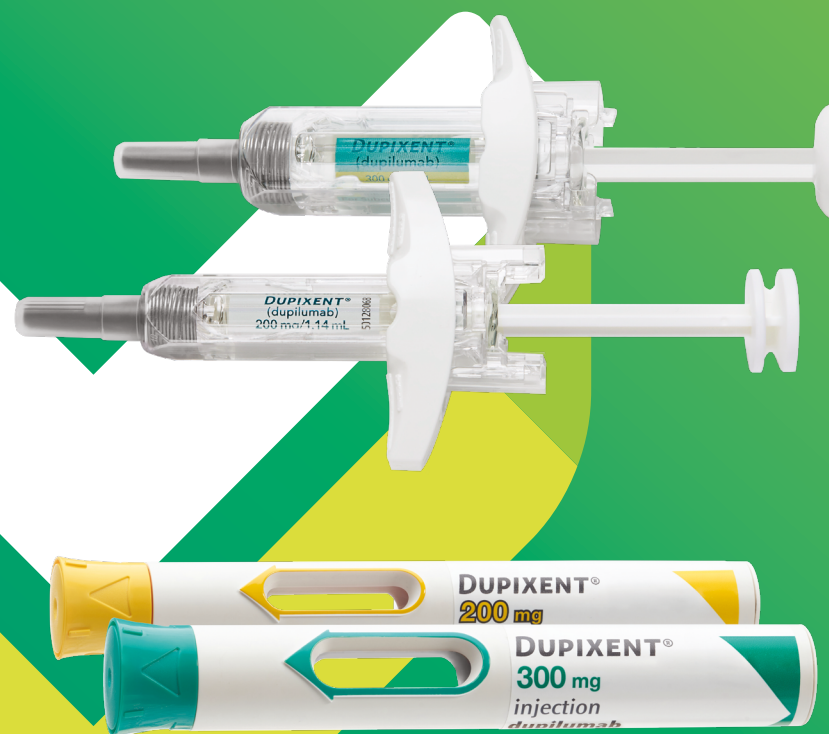

Please refer to page 28 if you are using a pre-filled syringe or page 36 if you are using a pre-filled pen.

"I AM USING A PRE-FILLED SYRINGE!"



IMPORTANT INFORMATION

This medicine can be self-administered and so it contains a needle. It is supplied in the form of a single-use pre-filled syringe.

You must not try to give yourself or someone else the injection unless you have received training from your healthcare professional.

- » Read all of the instructions carefully before using the syringe
- » Check with your healthcare professional how often you will need to inject the medicine

If you are using a pre-filled pen, please refer to page 36.

Do

- » Ask your healthcare professional to show you the right way to use the syringe before you inject for the first time
- » Alternate the injection site for each injection
- » Keep the syringe(s) out of the reach of children
- » Keep unused syringes in the original carton and store in the refrigerator between 2°C and 8°C
- » Keep the syringes in the original carton to protect the medicine from light

Do not

- » Use the syringe if it has been dropped on a hard surface or damaged
- » Use the syringe if the needle cap is missing or not securely attached
- » Touch the plunger rod until you are ready to inject
- » Inject through clothes
- » Get rid of any air bubbles in the syringe
- » Pull back on the plunger rod
- » Reuse the syringe
- » Shake the syringe at any time
- » Store above 25°C
- » Keep DUPIXENT at room temperature (above refrigerator temperature and below 25°C) for more than 14 days. If you need to permanently remove the carton from the refrigerator, write down the date of removal in the space provided on the outer carton, and use DUPIXENT within 14 days
- » Heat the syringe
- » Freeze the syringe
- » Place the syringe into direct sunlight

Preparing for your injection

The parts of the DUPIXENT pre-filled syringe (including needle shield) are shown in this picture.

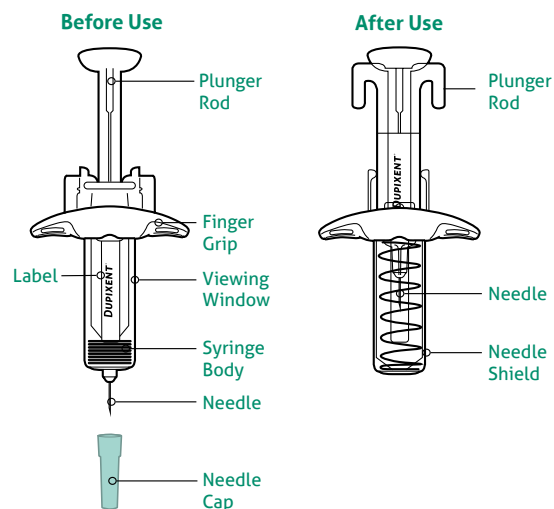

To help prevent accidental needle injury, each pre-filled syringe has a needle shield that is automatically activated to cover the needle after you have given your injection.

STEP 2: PREPARE

Ensure you have the following:

- DUPIXENT pre-filled syringe
- 1 alcohol wipe*
- 1 cotton ball or gauze*
- Puncture-resistant container* (See Step 12)

*Items not included in the carton.

Look at the label:

- Check the expiry date
- Check that you have the correct product and dose

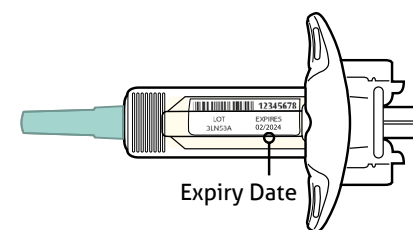

Do not use the syringe if the expiry date has passed.

Do not keep DUPIXENT at room temperature for more than 14 days.

STEP 1: REMOVE

Remove the syringe from the carton by holding the middle of the syringe body.

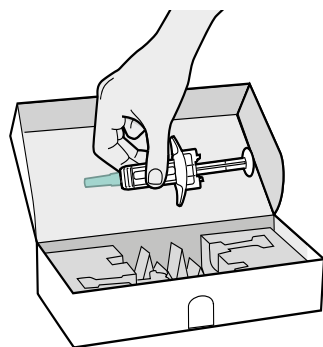

Do not pull off the needle cap until you are ready to inject.

Do not use the syringe if it has been damaged.

STEP 3: INSPECT

Look at the medicine through the viewing window on the syringe:

- Check if the liquid is clear and colourless to pale yellow

Note: You may see an air bubble; this is normal.

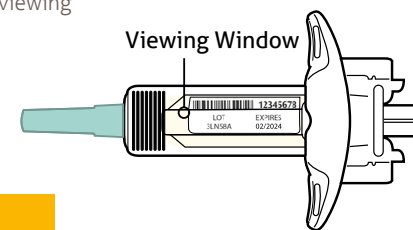

Do not use the syringe if the liquid is discoloured/cloudy, or contains flakes/particles.

STEP 4: WAIT

Lay the syringe on a flat surface and wait to let it get to room temperature naturally:

- » Wait 30 minutes for the 200 mg pre-filled syringe
- » Wait 45 minutes for the 300 mg pre-filled syringe

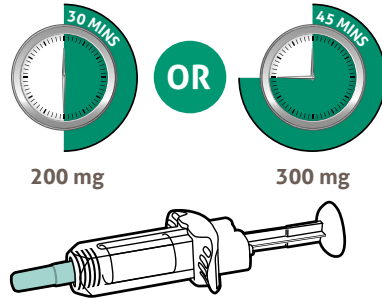

- » **Do not** heat the syringe.
- » **Do not** place the syringe in direct sunlight.

STEP 5: CHOOSE

Select the injection site. The recommended injection sites are:

- » Thighs
- » Stomach (except for the 5 cm around your navel [belly button])
- » If somebody else gives you the injection, they can also use your upper arms

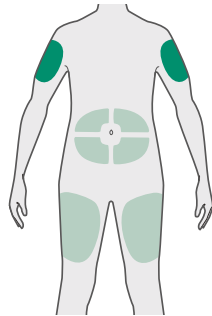

- = Self-injection or by caregiver
- = Injection by caregiver only

- » **Do not** inject through clothes.
- » **Do not** inject into skin that is tender, damaged or has bruises/scars.

STEP 6: CLEAN

- » Wash your hands
- » Clean the injection site with an alcohol wipe
- » Let your skin dry before injecting

- » **Do not** touch the injection site again or blow on it before the injection.



STEP 7: PULL

Hold the syringe in the middle of the syringe body with the needle pointing away from you and pull off the needle cap.

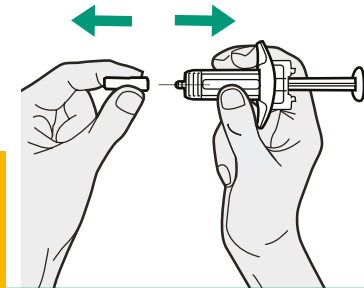

- » **Do not** put the needle cap back on.
- » **Do not** touch the needle.
- » Inject your medicine immediately after removing the needle cap.

STEP 8: PINCH

Using your thumb and index finger, pinch a fold of skin at the injection site.

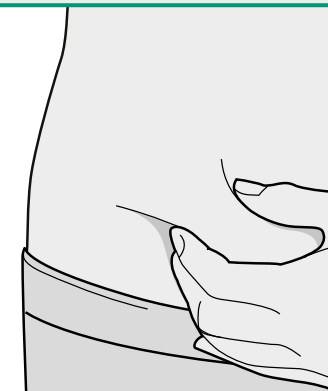

STEP 9: INSERT

Insert the needle completely into the fold of skin at roughly a 45° angle.

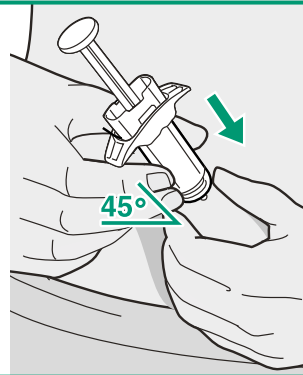

STEP 10: PUSH

Relax the pinch.

Slowly and steadily push the plunger rod down as far as it will go until the syringe is empty.

Note: You will feel some resistance. This is normal.

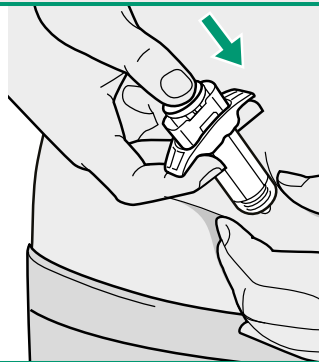

STEP 11: RELEASE AND REMOVE

Lift your thumb to release the plunger rod until the needle is covered by the needle shield and then remove the syringe from the injection site.

Lightly press a cotton ball or gauze on the injection site if you see any blood.

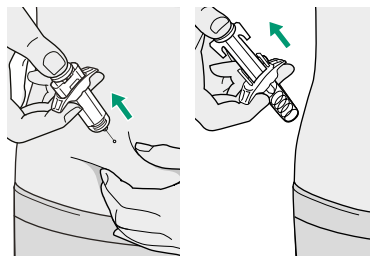

Do not put the needle cap back on.

Do not rub your skin after the injection.

STEP 12: DISPOSE

Dispose of the syringe and the needle cap in a puncture-resistant container.

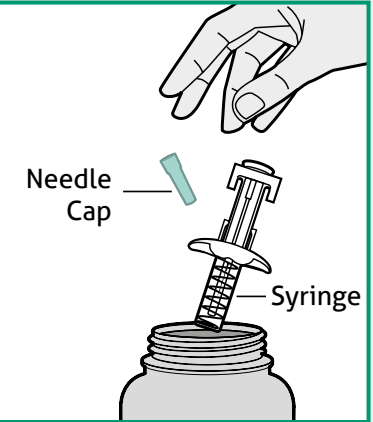

Do not put the needle cap back on.

Always keep the container out of reach of children.

How to store DUPIXENT

- » Keep DUPIXENT out of the sight and reach of children
- » **Do not** use DUPIXENT after the expiry date, which is stated on the label and carton after 'EXP'. The expiry date refers to the last day of that month
- » Store DUPIXENT in a refrigerator (2°C to 8°C). If necessary, pre-filled syringes may be kept at room temperature up to 25°C for a maximum of 14 days
- » **Do not** store DUPIXENT above 25°C. If you need to permanently remove the carton from the refrigerator, write down the date of removal in the space provided on the outer carton, and use it within 14 days. Store in the original carton to protect from light
- » **Do not** use DUPIXENT if you notice that the medicine is cloudy, discoloured, or has particles in it
- » **Do not** throw away any medicines, including DUPIXENT, via wastewater or household waste. Ask your healthcare professional how to throw away medicines you no longer use. These measures will help protect the environment

"I AM USING A PRE-FILLED PEN!"



IMPORTANT INFORMATION

This medicine can be self-administered. It is supplied in the form of a single-use pre-filled pen.

You must not try to give yourself or someone else the injection unless you have received training from your healthcare professional. Read all of the instructions carefully before using the pre-filled pen.

- » Read all of the instructions carefully before using the pre-filled pen
- » Check with your healthcare professional how often you will need to inject the medicine

If you are using a pre-filled syringe, please refer to page 28.

Do

- » Ask your healthcare professional to show you the right way to use the pre-filled pen before you inject for the first time
- » Alternate the injection site for each injection
- » Keep the pre-filled pen out of the reach of children
- » Keep the unused pre-filled pen in the original carton and store in the refrigerator between 2°C and 8°C
- » Keep the pre-filled pen in the original carton to protect the medicine from light

Do not

- » Use the pre-filled pen if it has been dropped on a hard surface or damaged
- » Use the pre-filled pen if the needle cap is missing or not securely attached
- » Press or touch the needle cover with your fingers
- » Inject through clothes
- » Remove the cap until just before you give the injection
- » Try to put the cap back on the pre-filled pen
- » Reuse the pre-filled pen
- » Shake the pre-filled pen at any time
- » Store above 25°C
- » Keep DUPIXENT at room temperature (above refrigerator temperature and below 25°C) for more than 14 days. If you need to permanently remove the carton from the refrigerator, write down the date of removal in the space provided on the outer carton, and use DUPIXENT within 14 days
- » Heat the pre-filled pen
- » Freeze the pre-filled pen
- » Place the pre-filled pen into direct sunlight

Preparing for your injection

The parts of the DUPIXENT pre-filled pen (including needle cover) are shown in this picture.

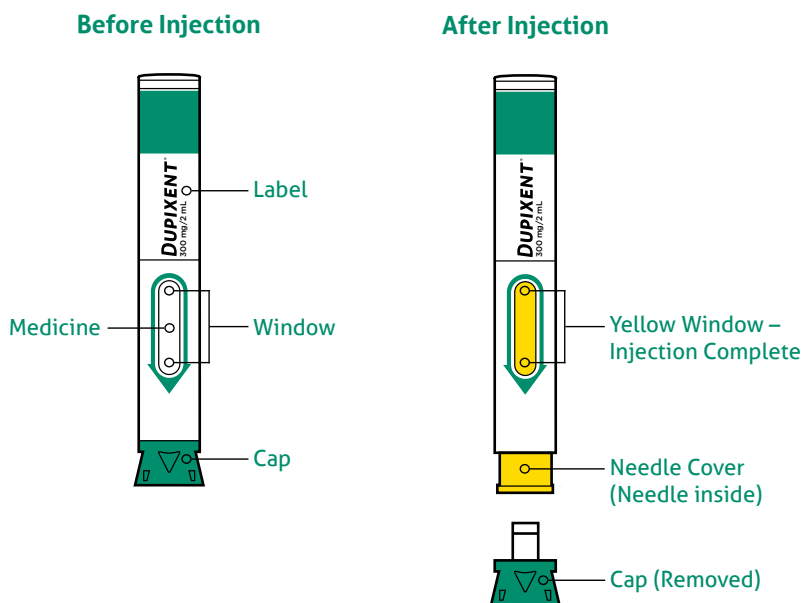

STEP 1: PREPARE

Ensure you have the following:

- » DUPIXENT pre-filled pen
- » 1 alcohol wipe*
- » 1 cotton ball or gauze*
- » A puncture-resistant container* (See Step 11)

*items not included in the carton.



Look at the Label

Look at the label:

- » Check the expiry date
- » Check that you have the correct product and dose



Do not use the pre-filled pen if the expiry date has passed.

Do not keep DUPIXENT at room temperature for more than 14 days.

STEP 2: INSPECT

Look at the medicine through the viewing window on the pre-filled pen:

- » Check if the liquid is clear and colourless to pale yellow

Note: You may see an air bubble; this is normal.

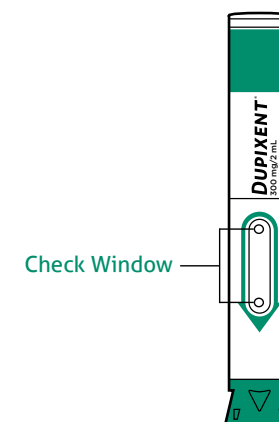

Do not use the pre-filled pen if the liquid is discoloured/cloudy, or contains flakes/particles.

Do not use the pre-filled pen if the window is yellow.

STEP 3: WAIT

Lay the pre-filled pen on a flat surface and wait to let it get to room temperature naturally:

- » Wait 30 minutes for the 200 mg pre-filled pen
- » Wait 45 minutes for the 300 mg pre-filled pen

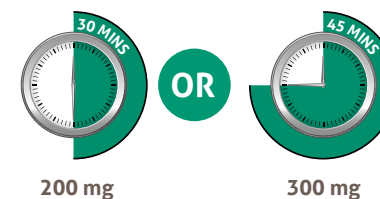

Do not heat the pre-filled pen.

Do not place the pre-filled pen in direct sunlight.

STEP 4: CHOOSE

Select the injection site. The recommended injection sites are:

- » Thighs
- » Stomach (except for the 5 cm around your navel [belly button])
- » If somebody else gives you the injection, they can also use your upper arms

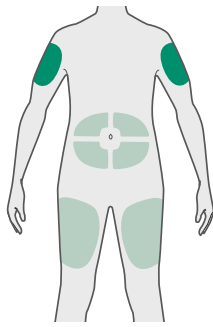

- = Self-injection or by caregiver
- = Injection by caregiver only

Change the injection site for each injection.



Do not inject through clothes.

Do not inject into skin that is tender, damaged or has bruises/scars.

STEP 5: CLEAN

- » Wash your hands
- » Clean the injection site with an alcohol wipe
- » Let your skin dry before injecting



Do not touch the injection site again or blow on it before the injection.

STEP 6: PULL

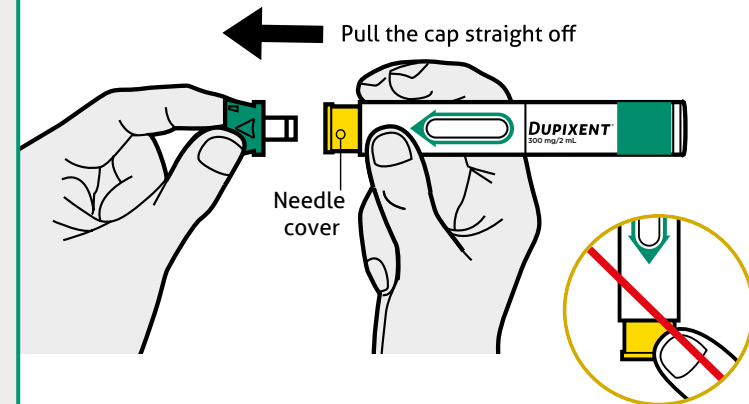

Pull the cap straight off. The needle is inside the needle cover.

Do not twist the cap off.

Do not remove the cap until you are ready to inject.



Do not press or touch the needle cover with your fingers.

Do not put the cap back on the pre-filled pen after you have removed it.

STEP 7: PLACE

When placing the needle cover on your skin, hold the pre-filled pen so that you can see the window. Place the needle cover on your skin at approximately a 90° angle.

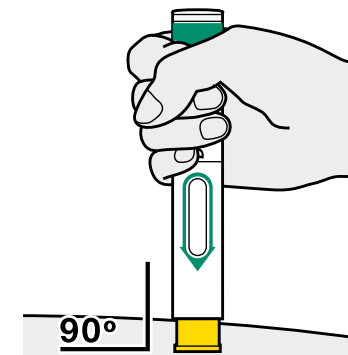

STEP 8: PRESS DOWN

Press the pre-filled pen firmly against your skin until you cannot see the needle cover, and hold. There will be a “click” when the injection starts. The window will start to turn yellow. The injection can take up to 20 seconds.

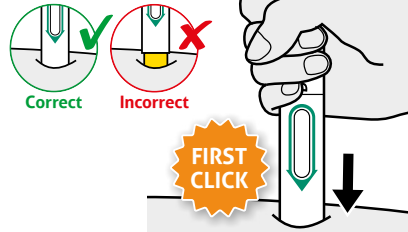

STEP 9: HOLD

Keep holding the pre-filled pen firmly against your skin. You may hear a second “click”. Check that the entire window has turned to yellow, then slowly count to 5. Then lift the pen up off the skin, your injection is complete.

If the window does not turn completely yellow, remove the pen and call your healthcare professional.



Do not give yourself a second dose without speaking to your healthcare professional.

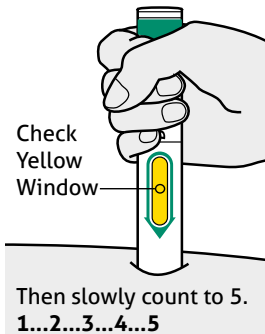

STEP 10: REMOVE

After you have completed your injection pull straight up to remove the pre-filled pen from the skin. If you see any blood at the site, lightly dab with a cotton ball or gauze pad.



Do not rub your skin after the injection.

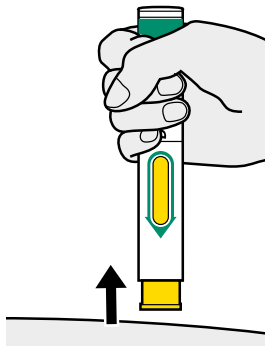

STEP 11: DISPOSE

Dispose of the pre-filled pen, (needle inside), and cap in a puncture-resistant container right away after use.



Do not put the needle cap back on. Always keep the container out of reach of children.

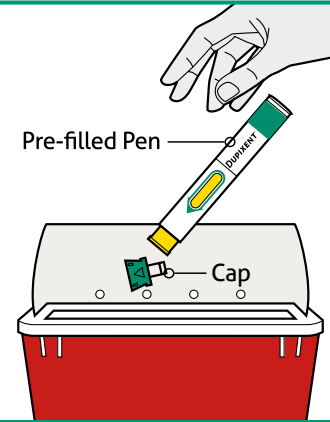

How to store DUPIXENT

- » Keep DUPIXENT out of the sight and reach of children
- » **Do not** use DUPIXENT after the expiry date, which is stated on the label and carton after 'EXP'. The expiry date refers to the last day of that month
- » **Do not** freeze DUPIXENT
- » **Do not** store DUPIXENT above 25°C. If you need to permanently remove the carton from the refrigerator, write down the date of removal in the space provided on the outer carton, and use it within 14 days. Store in the original carton to protect from light
- » **Do not** use DUPIXENT if you notice that the medicine is cloudy, discoloured, or has particles in it
- » **Do not** throw away any medicines, including DUPIXENT, via wastewater or household waste. Ask your healthcare professional how to throw away medicines you no longer use. These measures will help protect the environment

STARTING A NEW TREATMENT SHOULD NOT BE OVERWHELMING

To help you better manage your disease and ensure that you get the maximum results from your treatment please scan this QR code and explore the support available to you.



MY NOTES

This handbook is not intended to be a substitute for medical advice

Please refer to the **Patient Information Leaflet** in the pack for full safety information and instructions for injection.

Reporting of side effects

You can help by reporting any side effects you may get.

If you get any side effects, talk to your healthcare professional. This includes any possible side effects not listed in this booklet or the Patient Information leaflet. You can also report side effects directly via the national reporting systems below:

In the UK:

Through the national MHRA Yellow Card scheme reporting system:
www.mhra.gov.uk/yellowcard

In Ireland:

Website: www.hpra.ie
Email: medsafety@hpra.ie
Tel: +353 1 6764971

Alternatively, contact Sanofi on:

Sanofi, 410 Thames Valley Park Drive,
Reading, Berkshire, RG6 1PT
+44 (0)800 0902314 (UK)
+353 1 403 5600 (Ireland)

By reporting side effects, you can help provide more information on the safety of this medicine.

Although every effort is made to ensure the accuracy of the information in this handbook, you should consult your healthcare professional for specific advice about your condition. Sanofi cannot accept any liability for any reliance you place on general advice in this handbook.

sanofi | **REGENERON**[®]

Sanofi and Regeneron are collaborating in a global development programme and commercialisation for DUPIXENT.

Copyright © 2023 Sanofi. All rights reserved.